

# LMP 331

## Screw-In Transmitter

Stainless Steel Sensor

accuracy according to IEC 60770:  
standard: 0.35 % FSO  
option: 0.25 % / 0.1 % FSO



### Nominal pressure

from 0 ... 100 mbar up to 0 ... 40 bar

### Output signals

2-wire: 4 ... 20 mA

3-wire: 0 ... 20 mA / 0 ... 10 V

others on request

### Special characteristics

- ▶ pressure port G 3/4" flush
- ▶ excellent accuracy
- ▶ small thermal effect
- ▶ excellent long term stability

### Optional versions

- ▶ accuracy 0.1% FSO IEC 60770
- ▶ IS-version: Ex ia = intrinsically safe for gases and dusts
- ▶ SIL 2 application according to IEC 61508 / IEC 61511
- ▶ different electrical connections
- ▶ customer specific versions  
e. g. special pressure ranges

The screw-in transmitter LMP 331 has been designed for continuous level measurement and is characterized by an excellent performance and a robust construction. The modular construction allows the user the highest possible flexibility in the adaption of LMP 331.

Optional features like e.g. an intrinsically safe version or a functionally safe version (SIL 2) increase the advantages when launching and realizing projects for plants and systems.

### Preferred areas of use are



Plant and Machine Engineering



Energy Industry



Environmental Engineering  
(water – sewage – recycling)



Input pressure range																
Nominal pressure gauge	[bar]	0.10	0.16	0.25	0.40	0.60	1	1.6	2.5	4	6	10	16	25	40	
Level	[mH <sub>2</sub> O]	1	1.6	2.5	4	6	10	16	25	40	60	100	160	250	400	
Overpressure	[bar]	0.5	1	1	2	5	5	10	10	20	40	40	80	80	105	
Burst pressure ≥	[bar]	1.5	1.5	1.5	3	7.5	7.5	15	15	25	50	50	120	120	210	
Vacuum resistance		P <sub>N</sub> ≥ 1 bar: unlimited vacuum resistance P <sub>N</sub> < 1 bar: on request														
Output signal / Supply																
Standard		2-wire: 4 ... 20 mA / V <sub>S</sub> = 8 ... 32 V <sub>DC</sub>									SIL-version: V <sub>S</sub> = 14 ... 28 V <sub>DC</sub>					
Option IS-version		2-wire: 4 ... 20 mA / V <sub>S</sub> = 10 ... 28 V <sub>DC</sub>									SIL-version: V <sub>S</sub> = 14 ... 28 V <sub>DC</sub>					
Options 3-wire		3-wire: 0 ... 20 mA / V <sub>S</sub> = 14 ... 30 V <sub>DC</sub> 0 ... 10 V / V <sub>S</sub> = 14 ... 30 V <sub>DC</sub>														
Performance																
Accuracy <sup>1</sup>		standard: nominal pressure < 0.4 bar: ≤ ± 0.5 % FSO nominal pressure ≥ 0.4 bar: ≤ ± 0.35 % FSO option 1: nominal pressure ≥ 0.4 bar: ≤ ± 0.25 % FSO option 2: for all nominal pressures: ≤ ± 0.1 % FSO														
Permissible load		current 2-wire: R <sub>max</sub> = [(V <sub>S</sub> - V <sub>Smin</sub> ) / 0.02 A] Ω current 3-wire: R <sub>max</sub> = 500 Ω voltage 3-wire: R <sub>min</sub> = 10 kΩ														
Influence effects		supply: 0.05 % FSO / 10 V load: 0.05 % FSO / kΩ														
Long term stability		≤ ± 0.1 % FSO / year at reference conditions														
Response time <sup>2</sup>		2-Leiter: ≤ 10 msec 3-Leiter: ≤ 3 msec														
<sup>1</sup> accuracy according to IEC 60770 – limit point adjustment (non-linearity, hysteresis, repeatability)																
<sup>2</sup> with optional accuracy 0,1 % FSO the response time is 200 msec																
Thermal effects (Offset and Span)																
Nominal pressure P <sub>N</sub>	[bar]	≤ 0.40									> 0.40					
Tolerance band	[% FSO]	≤ ± 1									≤ ± 0.75					
in compensated range	[°C]	0 ... 70									-20 ... 85					
Permissible temperatures																
Permissible temperatures		medium: -40 ... 125 °C electronics / environment: -40 ... 85 °C storage: -40 ... 100 °C														
Electrical protection																
Short-circuit protection		permanent														
Reverse polarity protection		no damage, but also no function														
Electromagnetic compatibility		emission and immunity according to EN 61326														
Mechanical stability																
Vibration		10 g RMS (25 ... 2000 Hz)									according to DIN EN 60068-2-6					
Shock		500 g / 1 msec									according to DIN EN 60068-2-27					
Explosion protection (only for 4 ... 20 mA / 2-wire)																
Approvals DX19-LMP 331		IBExU 10 ATEX 1068 X / IECEx IBE 12.0027X zone 0: II 1G Ex ia IIC T4 Ga zone 20: II 1D Ex ia IIIC T 85°C Da														
Safety technical maximum values		U <sub>i</sub> = 28 V, I <sub>i</sub> = 93 mA, P <sub>i</sub> = 660 mW, C <sub>i</sub> ≈ 0nF, L <sub>i</sub> ≈ 0 μH, the supply connections have an inner capacity of max. 27 nF opposite the housing														
Permissible temperature for medium		in zone 0: -20 ... 60 °C with p <sub>atm</sub> 0.8 bar bis 1.1 bar in zone 1 or higher: -20 ... 70 °C														
Conneting cables (by factory)		cable capacitance: signal line/shield also signal line / signal line: 160 pF/m cable inductance: signal line /shield also signal line / signal line: 1 μH/m														
Materials																
Pressure port		stainless steel 1.4404 (316L)														
Housing		stainless steel 1.4404 (316L)														
Seals		standard: FKM option: EPDM others on request														
Diaphragm		stainless steel 1.4435 (316L)														
Media wetted parts		pressure port, seals, diaphragm														

# LMP 331

Stainless Steel Screw-In Transmitter

Technical Data

Miscellaneous	
Optionally SIL 2 application	according to IEC 61508 / IEC 61511
Current consumption	signal output current: max. 25 mA signal output voltage: max. 7 mA
Weight	approx. 200 g
Installation position	any <sup>3</sup>
Operational life	> 100 x 10 <sup>6</sup> cycles
CE-conformity	EMC Directive: 2014/30/EU
ATEX Directive	94/9/EG

<sup>3</sup> Pressure transmitters are calibrated in a vertical position with the pressure connection down. If this position is changed on installation there can be slight deviation in the zero point for pressure ranges  $P_N \leq 1$  bar.

### Pin configuration

Electrical connections	ISO 4400	Binder 723 (5-pin)	M12x1 / metal (4-pin)	field housing	cable colours (IEC 60575)
Supply +	1	3	1	IN +	wh (white)
Supply -	2	4	2	IN -	bn (brown)
Signal + (only for 3-wire)	3	1	3	OUT +	gn (green)
Shield	ground pin	5	4	⊥	gnye (green-yellow)

### Wiring diagrams

2-wire-system (current)

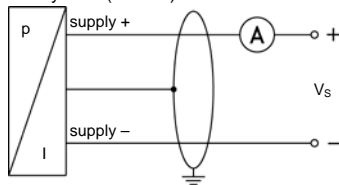

3-wire-system (current/voltage)

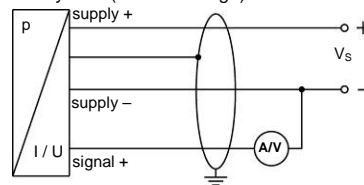

### Electrical connections (dimensions in mm)

standard

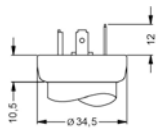

ISO 4400 (IP 65)

option

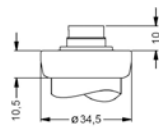

Binder Series 723 5-pin (IP 67)

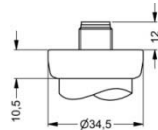

M12x1 4-pin (IP 67)

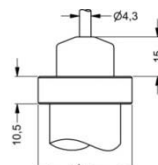

cable outlet with PVC cable (IP 67)<sup>4</sup>

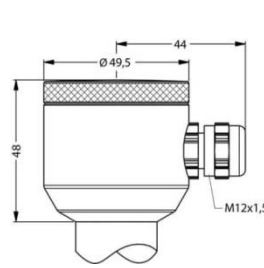

compact field housing (IP 67)

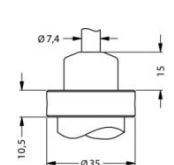

cable outlet, cable with ventilation tube (IP 68)<sup>5</sup>

<sup>4</sup> standard: 2 m PVC cable (without ventilation tube, permissible temperature: -5 ... 70 °C)

<sup>5</sup> different cable types and lengths available, permissible temperature depends on kind of cable

### Mechanical connection (dimensions in mm)

standard

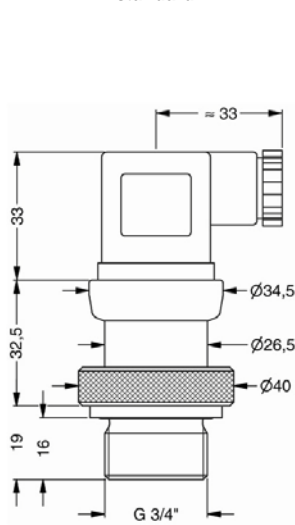

G3/4" flush (DIN 3852) with ISO 4400

standard for SIL- and SIL-Ex-version<sup>6</sup>

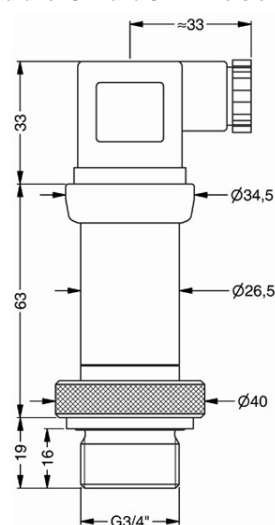

G3/4" flush (DIN 3852) with ISO 4400

<sup>6</sup> not in combination with the accuracy 0.1%

