

100V-240V AC



Approval Marks



Certified

EN 61347-1:2008  
EN 61347-2-13:2006  
EN 62384:2006

Electronic

Parameter	Conditions	Min	Nom	Max	Unit
I/P Voltage Range		90	230	264	Vac
Input Frequency		47	50-60	63	Hz
Output Power(Pout)	350mA LED	1	-	3	W
Input Current(Iin)	25°C, Nominal Input@230VAC	-	55	-	mA
Output Voltage(Vout)		3	-	9	Vdc
Output Current(Iout)	25°C, Nominal Input	300	350	385	mA
Power Factor	Full Load	-	0.40	-	
Protection	Overload Protection				
	Short Circuit Protection				
	Over Heat Protection				
Ambient Temp.		-20	-	+50	°C
Case Temp. (Tc)	Normal Conditions	-	-	+70	°C

Lamp Type High Power LED 1.2W x 1~2

Application Space

Indoor Use  
(Low Humidity, No Condensation)

Physical

Parameter

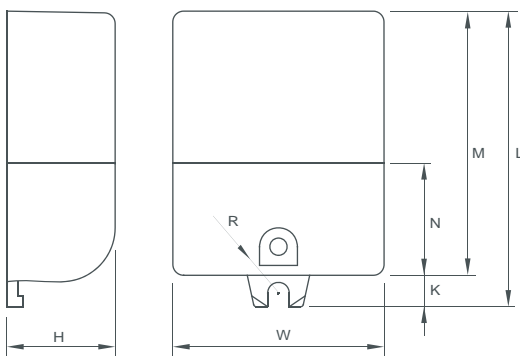

L : 55.8 mm    H : 20 mm  
M : 50 mm    K : 3 mm  
N : 21.8 mm    R : 2 mm  
W : 39 mm

Tolerance :  $\geq 0 \sim 100 \geq \pm 0.5\text{mm}$   
 $100 \geq \pm 1 \text{ mm}$

Terminal Block : PRI : Screw Type  
SEC : Screw Type

Housing Material : Polycarbonate

Soldering : Lead-Free, Comply With RoHS

Label : Surface Print

Wiring Diagram

