

FIBROFLEX®-Tubular spring element 95 Shore A, to DIN ISO 10069-1

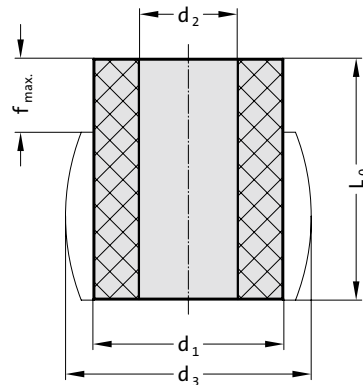

246.7.



Description:

FIBROFLEX® Spring Elements are made from highly elastic polyurethane elastomers. Shore hardness is the most significant rating of the various FIBROFLEX® elements. Shore hardness ratings are symbolized by distinctive colour coding. Correct selection of Shore hardness has a fundamental bearing on the success of FIBROFLEX®-applications.

Material:

Polyurethan 95 Shore A
Colour: red

Note:

The physical properties of polyurethane elastomers means that they have a tendency to settle. The extent of such settlement is dependent on the internal heat of friction, speed and number of load changes, the spring travel and the Shore hardness. Settlement may be as much as 4 to 7% of the spring length L_0 .

246.7. FIBROFLEX®-Tubular spring element 95 Shore A, to DIN ISO 10069-1

Order No	d ₁	L ₀	d ₂	d ₃	f max.	F max. [N]	Order No	d ₁	L ₀	d ₂	d ₃	f max.	F max. [N]
246.7.016.012	16	12.5	6.5	21	3.1	2000	246.7.100.080	100	80	21	130	20	89000
246.7.016.016	16	16	6.5	21	4	1920	246.7.100.100	100	100	21	130	25	87000
246.7.016.020	16	20	6.5	21	5	1900	246.7.100.125	100	125	21	130	31.2	86000
246.7.016.025	16	25	6.5	21	6.2	1870	246.7.125.032	125	32	27	160	8	178000
246.7.020.016	20	16	8.5	26	4	3050	246.7.125.040	125	40	27	160	10	168000
246.7.020.020	20	20	8.5	26	5	3000	246.7.125.050	125	50	27	160	12.5	157000
246.7.020.025	20	25	8.5	26	6.2	2980	246.7.125.063	125	63	27	160	15.7	150000
246.7.020.032	20	32	8.5	26	8	2950	246.7.125.080	125	80	27	160	20	142000
246.7.025.020	25	20	10.5	32	5	5100	246.7.125.100	125	100	27	160	25	135000
246.7.025.025	25	25	10.5	32	6.2	5080	246.7.125.125	125	125	27	160	31.2	133000
246.7.025.032	25	32	10.5	32	8	5020	246.7.125.160	125	160	27	160	40	130000
246.7.025.040	25	40	10.5	32	10	5000							
246.7.032.032	32	32	13.5	42	8	7600							
246.7.032.040	32	40	13.5	42	10	7500							
246.7.032.050	32	50	13.5	42	12	7480							
246.7.032.063	32	63	13.5	42	15.7	7450							
246.7.040.032	40	32	13.5	52	8	13000							
246.7.040.040	40	40	13.5	52	10	12700							
246.7.040.050	40	50	13.5	52	12.5	12500							
246.7.040.063	40	63	13.5	52	15.7	12450							
246.7.040.080	40	80	13.5	52	20	12430							
246.7.050.032	50	32	17	65	8	21000							
246.7.050.040	50	40	17	65	10	20100							
246.7.050.050	50	50	17	65	12.5	19600							
246.7.050.063	50	63	17	65	15.7	19200							
246.7.050.080	50	80	17	65	20	19100							
246.7.050.100	50	100	17	65	25	19050							
246.7.063.032	63	32	17	81	8	37000							
246.7.063.040	63	40	17	81	10	35900							
246.7.063.050	63	50	17	81	12.5	34000							
246.7.063.063	63	63	17	81	15.7	33000							
246.7.063.080	63	80	17	81	20	32000							
246.7.063.100	63	100	17	81	25	31800							
246.7.063.125	63	125	17	81	31.2	31600							
246.7.080.032	80	32	21	104	8	62500							
246.7.080.040	80	40	21	104	10	59000							
246.7.080.050	80	50	21	104	12.5	58000							
246.7.080.063	80	63	21	104	15.7	55000							
246.7.080.080	80	80	21	104	20	54000							
246.7.080.100	80	100	21	104	25	53000							
246.7.080.125	80	125	21	104	31.2	52000							
246.7.100.032	100	32	21	130	8	110000							
246.7.100.040	100	40	21	130	10	102500							
246.7.100.050	100	50	21	130	12.5	95000							
246.7.100.063	100	63	21	130	15.7	92000							

246.7.016. Ø 16/95 Shore A

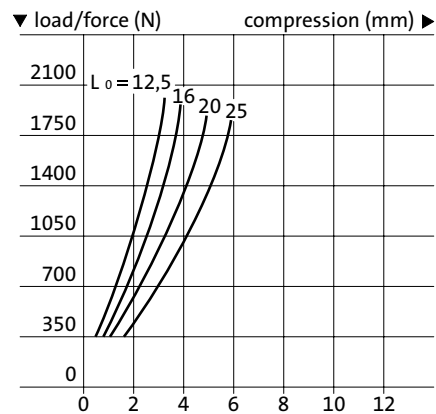

FIBROFLEX®-Tubular Spring Elements 95 Shore A

246.7.020.
Ø 20/95 Shore A

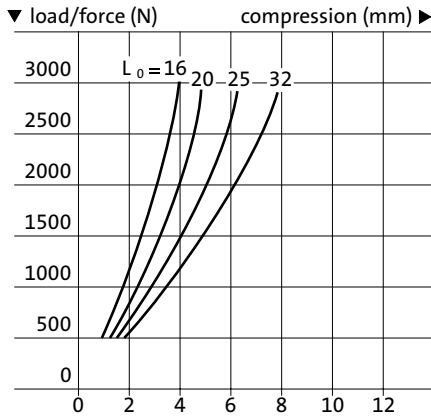

246.7.025.
Ø 25/95 Shore A

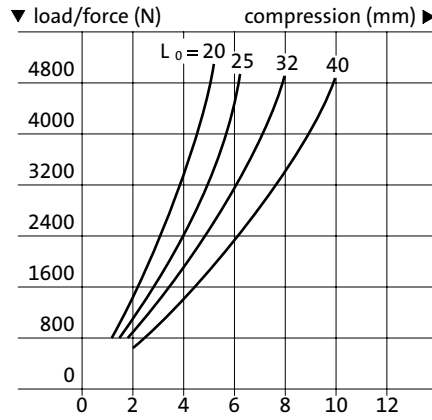

246.7.032.
Ø 32/95 Shore A

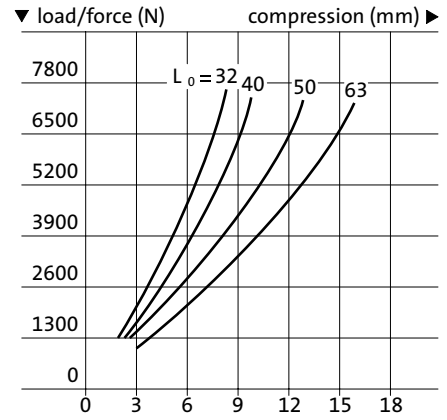

246.7.040.
Ø 40/95 Shore A

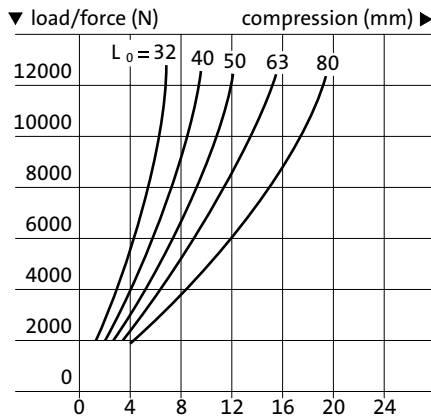

246.7.050.
Ø 50/95 Shore A

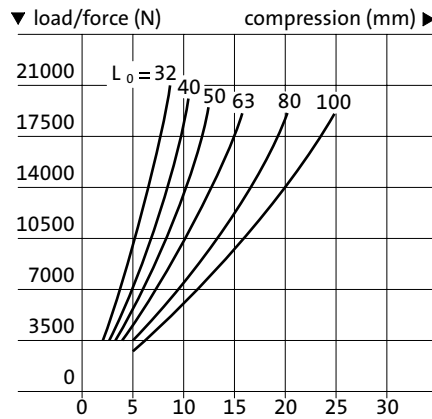

246.7.063.
Ø 63/95 Shore A

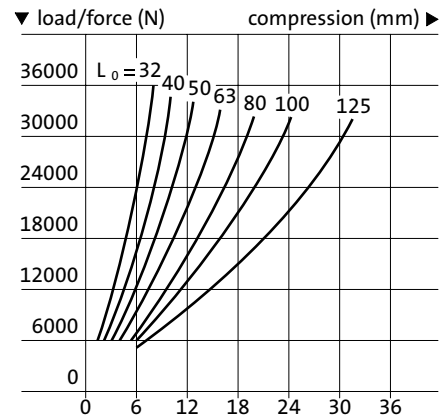

246.7.080.
Ø 80/95 Shore A

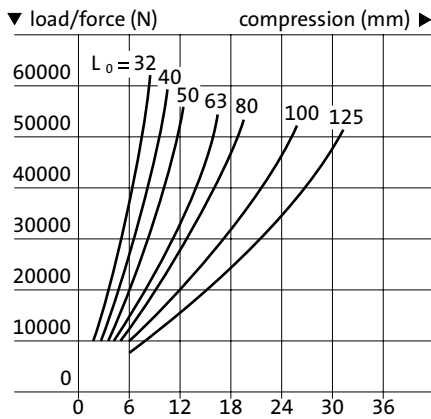

246.7.100.
Ø 100/95 Shore A

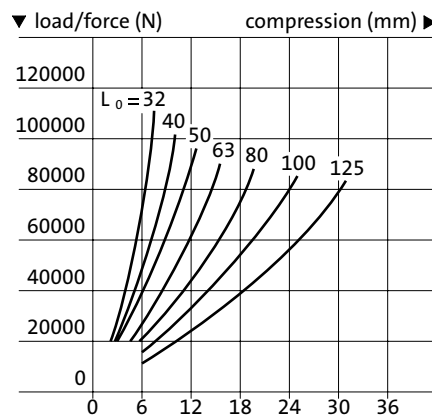

246.7.125.
Ø 125/95 Shore A

