

Oil-Free - Explosion Proof Pump
ATEX Certified



EX Series

Max Flow	17 l/min
Max Vacuum	560 mm Hg
Max Pressure	2.0 bar

Contamination free pumping

EX series pumps provide a clean oil free vacuum and pressure source in potentially explosive environments. Suitable for continuous duty the EX series is ideal for use in petrochemical industry where class IIC certification is required.

Adaptability and long life

The robust construction of the EX series ensures long term reliability even in continuous duty applications. EX series pumps are available for 110V or 230V and 50Hz or 60Hz supply ensuring suitability for worldwide operation. The pump performance can be customised to suit each client's requirements.

Fully explosion proof

Designed for use in the sampling and process control industry where explosive gases are present, the EX series incorporates an explosion proof motor, for certified installation in zone 1 and zone 2 areas to the enclosure group class EExd T4 IIC. In addition both models are ATEX certified.

Corrosion resistant options

The EX series can be upgraded with a range of optional material components providing resistance to a wide range of corrosive gases and vapours.

Application ideas

Application ideas include gas monitoring, hazardous area sampling, chemical processing and for use in the printing industry.

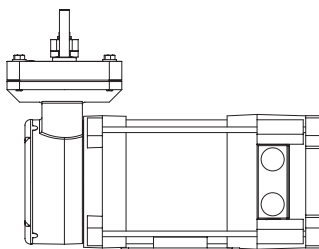

EX30 Single ended pump

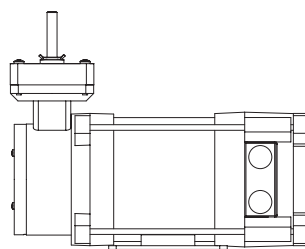

EX7 Single ended pump

EX30

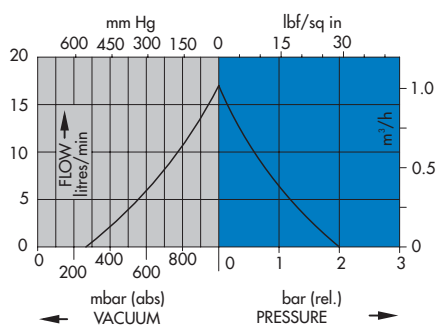

EX7

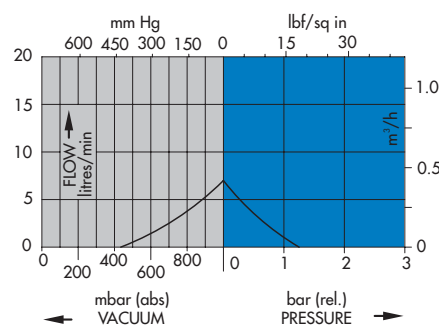

EX Series

Technical Specifications

Motor Type

IP65. Totally enclosed permanent capacitor explosion proof. 1450 RPM.

Electrical Connection: M20 threads to take cable glands for power and control circuit connections.

Model no.	110/115V 50/60Hz			230V 50Hz		
	Operating current	Max load	Fuse rating	Operating current	Max load	Fuse rating
EX7	0.8A	1.2A	2.0A	0.4A	0.6A	1.0A
EX30	0.8A	1.2A	2.0A	0.4A	0.6A	1.0A

Performance

Model no.	Max free flow l/min	Max vacuum mbar (abs)	Max pressure bar
EX7	7.0	430	1.2
EX30	17.0	270	2.0

Technical Drawing

EX7 7.9kg

dimensions: mm

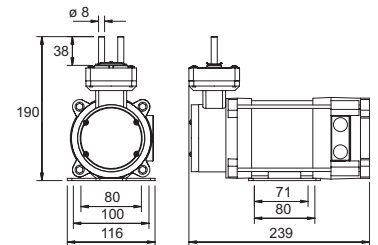

Pump Materials

With the option of appropriate materials for the head and flexibles, EX pumps will handle a wide range of corrosive gases.

EX30 8.3kg

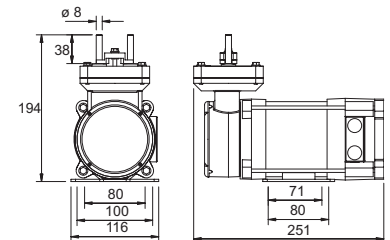

Component	Standard	Options
Head	Aluminium	Stainless Steel, PTFE coated Aluminium
Diaphragm/Valves	EPDM/Nitrile	PTFE, Viton
Connectors	Stainless Steel	PTFE
'O' Rings	Nitrile	PTFE, Viton

Distributed by:

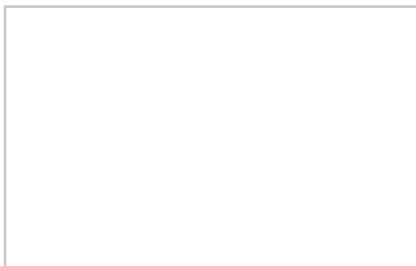

Connectors

Plain, vertical, stainless steel 8.0mm OD

Optional: plain, vertical, stainless steel 6.0, 6.4 mm OD and barbed, vertical, PTFE, 8.0mm OD

Please note - it is important that you ensure the motor specification stated and the range of materials offered in the pump are compatible with the performance, environmental limitations and chemical resistance requirements of the application.

For further information or details of our extensive range of pumps, contact our technical sales office who will be pleased to help you select the most suitable pump for your application

S30-227/3

