

N100C

**COIL-FED PNEUMATIC NAILERS
CLAVADORAS NEUMÁTICAS ALIMENTADAS POR ROLLO
CLOUEURS PNEUMATIQUES À ENROULEMENT**

BOSTITCH®

N100C

**COIL-FED PNEUMATIC NAILERS
CLAVADORAS NEUMÁTICAS ALIMENTADAS POR ROLLO
CLOUEURS PNEUMATIQUES À ENROULEMENT**



**TOOL PARTS ILLUSTRATION
ILUSTRACIÓN DE LAS PIEZAS DE LA HERRAMIENTA
ILLUSTRATION DES PIÈCES D'OUTILLAGE**

⚠WARNING:

⚠ADVERTENCIA:

⚠ATTENTION:

BEFORE PERFORMING REPAIRS ON THIS TOOL, ALL OPERATORS SHOULD STUDY THIS ILLUSTRATION, AS WELL AS THE PARTS LIST AND OPERATION AND MAINTENANCE MANUAL. OPERATORS SHOULD UNDERSTAND AND FOLLOW ALL SAFETY WARNINGS AND INSTRUCTIONS. KEEP THIS ILLUSTRATION WITH THE TOOL FOR FUTURE REFERENCE. IF YOU HAVE ANY QUESTIONS, CONTACT YOUR STANLEY-BOSTITCH REPRESENTATIVE OR DISTRIBUTOR.

ANTES DE LLEVAR A CABO CUALQUIER REPARACIÓN EN LA HERRAMIENTA, TODOS LOS OPERARIOS DEBERÁN ESTUDIAR ESTA ILUSTRACIÓN, ASÍ COMO LA LISTA DE PIEZAS Y EL MANUAL DE OPERACIÓN Y MANTENIMIENTO. LOS OPERARIOS DEBERÁN ENTENDER Y SEGUIR TODAS LAS ADVERTENCIAS E INSTRUCCIONES DE SEGURIDAD. CONSERVE ESTA ILUSTRACIÓN CON LA HERRAMIENTA PARA PODER CONSULTARLA EN LO FUTURO. SI TUVIERA ALGUNA PREGUNTA, PONGASE EN CONTACTO CON SU REPRESENTANTE O DISTRIBUIDOR DE STANLEY-BOSTITCH.

AVANT DE PROCÉDER À LA RÉPARATION DE CET OUTIL, LES OPÉRATEURS DOIVENT ÉTUDIER LA PRÉSENTE ILLUSTRATION AINSI QUE LA LISTE DE PIÈCES ET LE MANUEL D'INSTRUCTIONS ET D'ENTRETIEN ; ILS DOIVENT ÉGALEMENT COMPRENDRE ET OBSERVER LES CONSIGNES DE SÉCURITÉ ET LES INSTRUCTIONS. CONSERVER CETTE ILLUSTRATION AVEC L'OUTIL POUR RÉFÉRENCE FUTURE. SI VOUS AVEZ DES QUESTIONS, COMMUNIQUEZ AVEC VOTRE REPRÉSENTANT OU VOTRE DISTRIBUTEUR DE STANLEY-BOSTITCH.

IP1067-1REVK 05/07

BOSTITCH®
Stanley Fastening Systems L.P.

N100C

COIL-FED PNEUMATIC NAILERS CLAVADORAS NEUMÁTICAS ALIMENTADAS POR ROLLO CLOUEURS PNEUMATIQUES À ENROULEMENT

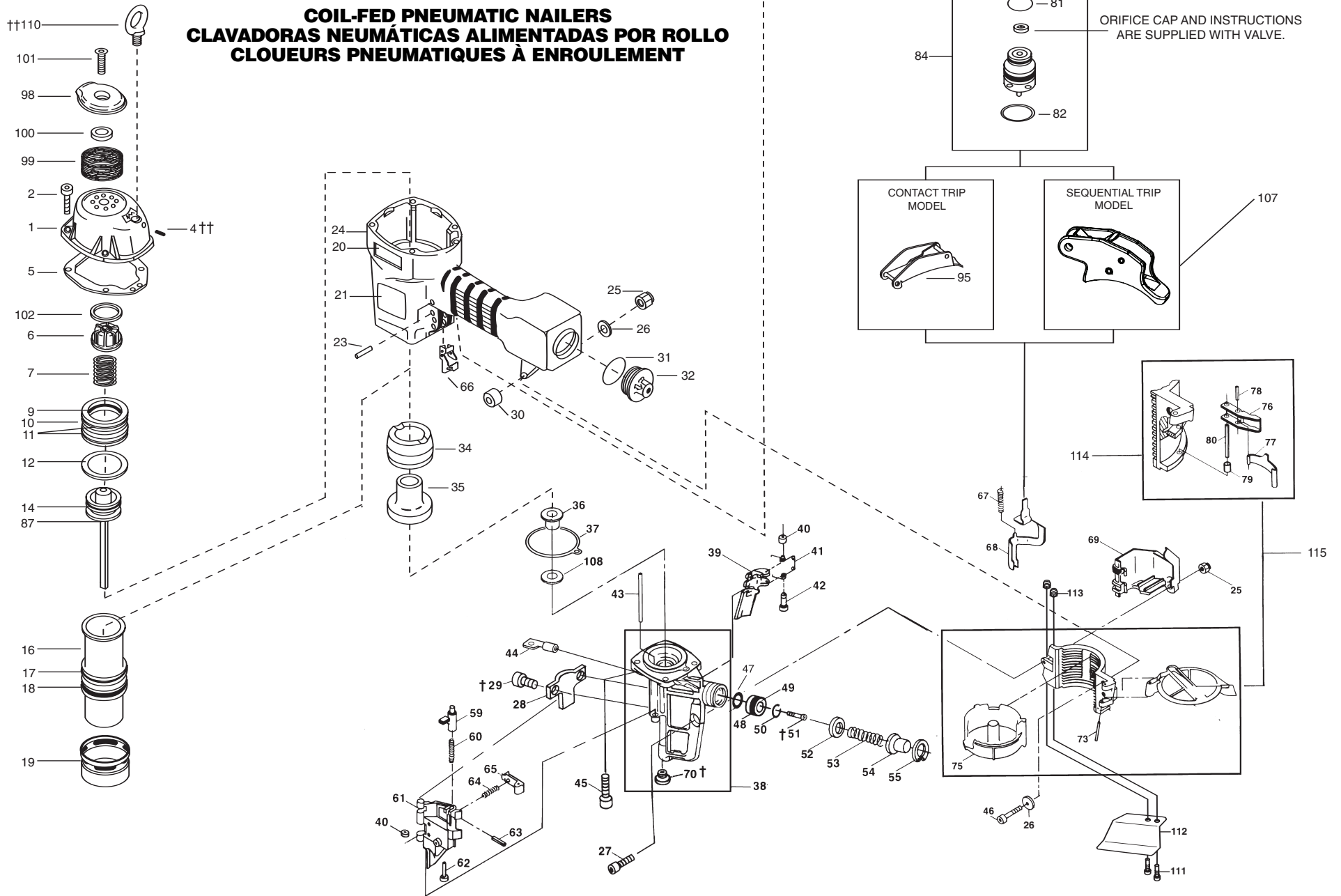

† Screw to feed piston rod with Loctite #271, available as part 851325 Loctite 271 Packet.

†† Assemble these threaded components with Loctite #242, available as part 851385.

IP1067-1REVK 05/07

TO BE USED WITH PARTS LIST IP1067-2 AND OPERATION AND MAINTENANCE MANUAL 102777

BOSTITCH

N100C		Parts List:		IP1067-2REVV	
To be Used with tool parts illustration:					
and operation and maintenance manual:				IP1067-1REVK	
Serial Number on the Tool:				102777	
				N100C 7153 000 and Higher	
ITEM	PART #	DESCRIPTION	ITEM	PART #	DESCRIPTION
1	105592	CAP (SERVICE PART)	61	N100101	DOOR
2	MSC6100-25	SCREW,SHCS,M6X1.00X25	62	N90107	CHECK PAWL STUD
4	MSS6100-6P	SCREW,CUPSSS,M6X1.00X6	63	MPP030012	PIN, SPIROL
5	N100131	SEAL, CYLINDER CAP	64	854011	COMPRESSION SPRING
6	N86132	PISTON STOP	65	N70149	PAWL CHECK
7	854017	SPRING,COMPRESSION	66	N70145	GUIDE,ARM
9	MRG051531	O-RING,2.028X.122	67	N90103	SPRING,COMPRESSION
10	105578	HEAD VALVE (SERVICE PART)	68	N100106	CONTACT ARM
11	851538	O-RING,2.675X.116	69	N100114	CONTACT ARM GUARD
12	N86125	HEAD VALVE SEAL	70	N100120	WEAR BUSHING
13	N100116	MAIN PISTON	73	UB5130	PIN,SPIROL 1/4 X 1 7/8
14	851539	O-RING,2.039X.253	75	N80103	BOTTOM,CANISTER
16	N90111	CYLINDER SLEEVE	76	N80109	LATCH, CANISTER
17	RG273710	O-RING,2.737X.103	77	N80108	SPRING,FLAT
18	N100128	SEAL, CHECK	78	UB2110.4	PIN, ROLL 1/8 X 5/8
19	N100317	LOWER SLEEVE	79	N80106	SPACER, LATCH
20	851880S	LABEL,STANLEY BOSTITCH	80	UB2126	PIN, ROLL 1/8 X 1 5/8 LONG
21	159912	LABEL,WARNING,COIL NAILERS	81	86459	O-RING,.614X.070
23	102549	PIN,SPECIAL SPIROL M3XM25	82	MRG019824	O-RING,.780X.094
24	N90110	FRAME	84	TVA6	KIT,TRIGGER VALVE
25	MHE6100-100	NUT,ESN M6X1	87	N100117A	ASSEMBLY,DRIVER/PISTON
26	MPW6.3	WASHER,PWN M6	95	CNTK2	KIT,CONTACT TRIP CONVERSION
27	MSC6100-35	SCREW,SHCS,M6X1.00X35	98	N100134A	COVER,EXHAUST
28	N100113	CONTACT ARM RETAINER	99	N100136	MUFFLER, EXHAUST
29	MSC6100-12	SCREW,SHCS,M6X1.00X12	100	N100138	SPACER, MUFFLER
30	N70143	BUSHING,RUBBER	101	MSC8125-28	SCREW,SHCS M8X28
31	850235	O-RING,1.487X.103	102	N100137	RING, BUMPER
32	T40207	CAP,END	107	SEQ6	KIT,SEQUENTIAL
34	N100129	BUMPER, OUTER	108	N100126	URETHANE WASHER
35	N100130	BUMPER, INNER	110	851756	HANGER
36	N100103	DRIVER,GUIDE	111	MSC5080-16	SCREW,SHCS,M5X0.80X16
37	106294	SEAL,NOSE	112	103031	GUARD, NAIL
38	105836	ASSEMBLY,NOSE & WEAR BUSHING	113	MHE5080-100	NUT,NYLON M5X.80
39	N100112	FEED PAWL	114	121632	ASSEMBLY,BRACKET
40	854004	WASHER,RUBBER-7	115	121635	ASSEMBLY,CANISTER
41	N80120	SPRING,TORSION			
42	N50087	PIN,SPECIAL(STEP)			
43	N90106	PIN,DOOR HINGE			
44	N80121	ROD,FEED PISTON			
45	MSC8125-30	SCREW,SHCS M8X30			
46	MSC6100-40	SCREW,SOC. HD. CAP M6X1.00X40			
47	MRG009824	O-RING,.386X.094			
48	851384	O-RING,.987X.103			
49	N80128	PISTON, FEED			
50	LW14.2	WASHER,1/4 HI COL LOCK			
51	MSC6100-16	SCREW,SHCS,M6X1.00X16			
52	N80123	BUMPER,FEED PISTON			
53	N80122	SPRING,COMPRESSION			
54	N80124	COVER, FEED PISTON			
55	851383	RING, RETAINING METRIC			
56	MRG004216	O-RING,.165X.063			
59	N70150	LATCH DOOR			
60	854013	SPRING,COMPRESSION			