

2- und 3-polig, IP 66

Fronteinbau 4-Loch-Befestigung



2-polig



3-polig



4-Loch (standard)

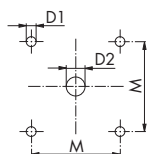

2-Loch (alternativ)
möglich wenn Maße N,
P und D3 angegeben

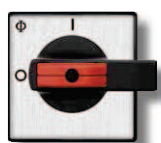
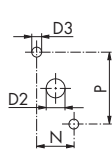

KG10A-KG64B

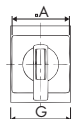
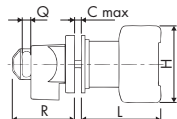

KG80-KG315

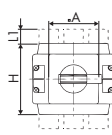
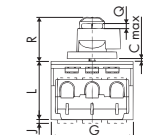

C316

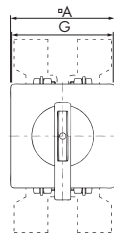
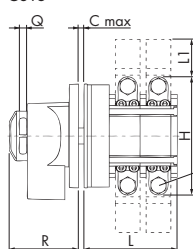

Maximale Anzahl Vorhängeschlösser		
Frontschild	Bügel-Ø	Anzahl Schlösser
48 x 48	7	3
	5	4
	8	3
64 x 64	5	4
	9	4
88 x 88	9	4
130 x 130	9	4

Dauerstrom (I _v /I _{th})	Schaltleistung AC-23B (A)	Frontschild	Artikelnummer	ab Lager lieferbar
2-polig 230 V				
20 A	1,5 kW	48 x 48 64 x 64	KG10A T202/04 E KG10B T202/04 E	●
3-polig 3 x 400 V				
20 A	5,5 kW	48 x 48 64 x 64	KG10A T203/04 E KG10B T203/04 E	●
25 A	7,5 kW	48 x 48 64 x 64	KG20A T203/04 E KG20B T203/04 E	●
32 A	11 kW	48 x 48 64 x 64	KG32A T203/04 E KG32B T203/04 E	●
40 A	15 kW	48 x 48 64 x 64	KG41 T203/04 E KG41B T203/04 E	●
63 A	22 kW	48 x 48 64 x 64	KG64 T203/04 E KG64B T203/04 E	●
80 A	30 kW	64 x 64 88 x 88	KG80 T203/04 E KG80C T203/04 E	●
100 A	37 kW	64 x 64 88 x 88	KG100 T203/04 E KG100C T203/04 E	●
125 A	45 kW	88 x 88	KG125 T203/04 E	●
160 A	55 kW	88 x 88	KG160 T203/04 E	●
200 A	75 kW	88 x 88	KG210 T203/05 E	●
250 A	90 kW	88 x 88	KG250 T203/05 E	●
315 A	110 kW	88 x 88	KG315 T203/05 E	●
315 A	132 kW	130 x 130	C316 T203/05 E ¹	●

Dauerstrom (I _v /I _{th})	Schaltleistung AC-23B (A)	Frontschild	Artikelnummer	ab Lager lieferbar
2-polig 230 V				
20 A	1,5 kW	48 x 48 64 x 64	KG10A T102/04 E KG10B T102/04 E	●
3-polig 3 x 400 V				
20 A	5,5 kW	48 x 48 64 x 64	KG10A T103/04 E KG10B T103/04 E	●
25 A	7,5 kW	48 x 48 64 x 64	KG20A T103/04 E KG20B T103/04 E	●
32 A	11 kW	48 x 48 64 x 64	KG32A T103/04 E KG32B T103/04 E	●
40 A	15 kW	48 x 48 64 x 64	KG41 T103/04 E KG41B T103/04 E	●
63 A	22 kW	48 x 48 64 x 64	KG64 T103/04 E KG64B T103/04 E	●
80 A	30 kW	64 x 64 88 x 88	KG80 T103/04 E KG80C T103/04 E	●
100 A	37 kW	64 x 64 88 x 88	KG100 T103/04 E KG100C T103/04 E	●
125 A	45 kW	88 x 88	KG125 T103/04 E	●
160 A	55 kW	88 x 88	KG160 T103/04 E	●
200 A	75 kW	88 x 88	KG210 T103/05 E	●
250 A	90 kW	88 x 88	KG250 T103/05 E	●
315 A	110 kW	88 x 88	KG315 T103/05 E	●
315 A	132 kW	130 x 130	C316 T103/05 E ¹	●

	Schalter							Lochbild							
	A	C	G	H	J	L	L1	Q	R	M	N	P	D1	D2	D3
KG10A 2-polig	48	4	48	50		38,7		7,2	51	36	12,2	30	5	11-15	3,5
KG10A 3-polig	48	4	48	50		48,2		7,2	51	36	12,2	30	5	11-15	3,5
KG10B 2-polig	64	4	48	50		45,7		8,1	58	48			5	11-15	
KG10B 3-polig	64	4	48	50		55,2		8,1	58	48			5	11-15	
KG20A, KG32A	48	4	42	54		53,8		7,2	51	36	12,2	30	5	10-15	3,5
KG20B, KG32B	64	4	42	54		53,8		8,1	58	48			5	10-15	
KG41, KG64	48	4	50	64		60,5		7,2	51	36			5	10-15	
KG41B	64	4	50	64		60,5		8,1	58	48			5	10-15	
KG64B	64	4	50	64		60,5		8,1	58	48	14	37	5	10-15	4,5
KG80, KG100	64	4	70	80	5,5	70,6	26	8,1	58	48	14	37	5	10-15	4,5
KG80C, KG100C	88	4	70	80	5,5	70,6	26	9	73	68			6	10-15	
KG125, KG160	88	5,5	112	108		96	22,2	9	73	68			6	13-17	
KG210, KG250	88	5,5	145	126	6	103	25	9	73	68			6	13-17	
KG315	88	5,5	145	126	6	103	25	9	73	68			6	13-17	
C316	130	7	128	150		117,2	46	9	86,5	104			7	16-20	

¹ Schutzart IP 40, auf Wunsch mit erhöhter Schutzart

Informationen zu KG-Schaltern mit Bolzenanschlüssen finden Sie auf Seite 61.

< Zurück zum Kapitelverzeichnis >



2-/3-polig



Komplett-/Lagergeräte

